

How do I use Bitwarden desktop?

You need to have your verified account. Learn here how to do it: <https://wiki.pv.eazy.cloud/books/bitwarden-password-manager/page/how-do-i-connect-to-bitwarden>



Step 01

- Download Bitwarden for your desktop PC: <https://bitwarden.com/download/>
- Follow the installation process and open the program.

This instruction is for **Microsoft Windows**, as most of you will use it. The installation with other operation systems should be very similar.

Step 02

- Click on Settings.

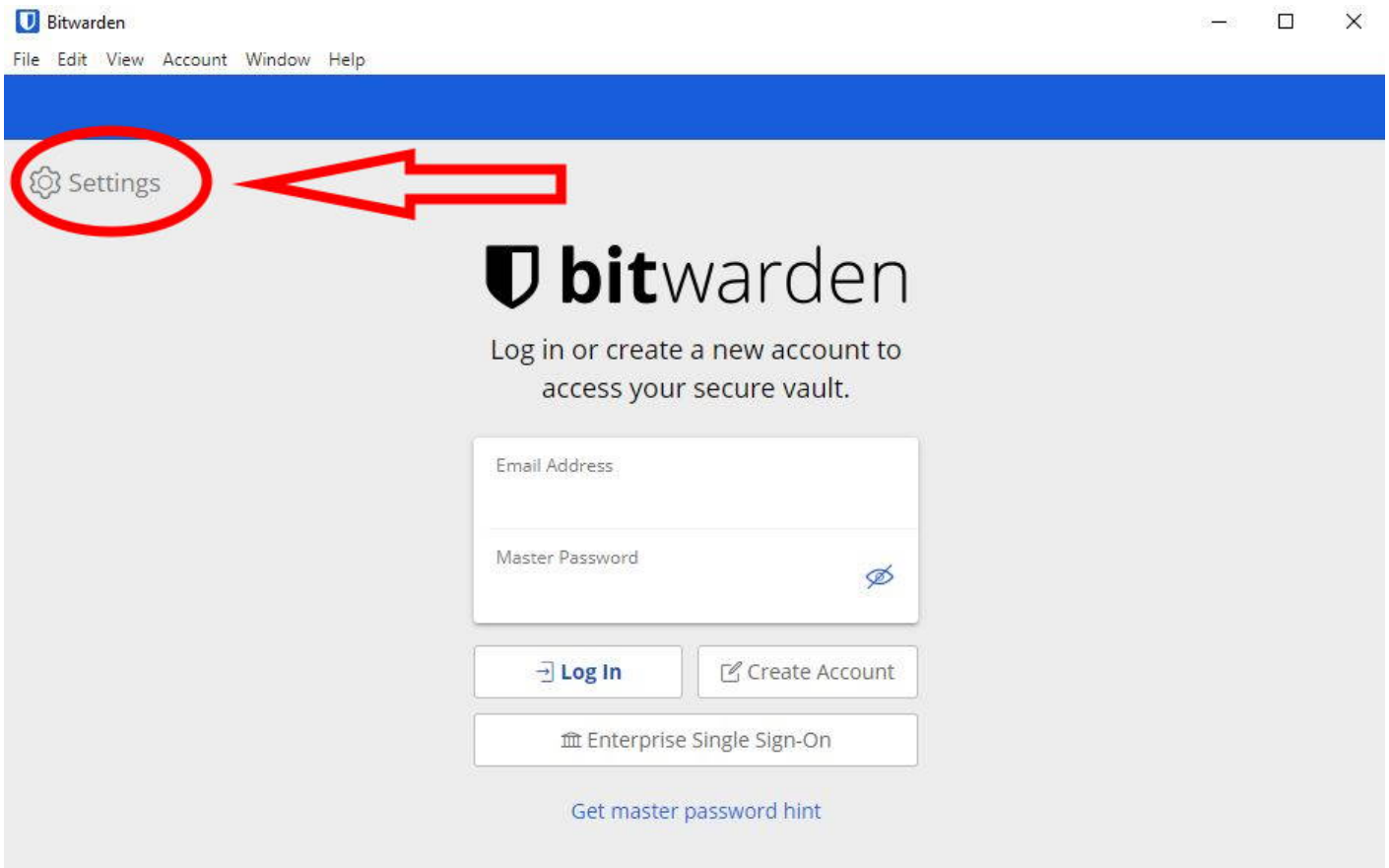

Step 03

- edit the Server URL to: <https://xxxx.eazy.cloud> (ask the Administrator!)
- click on save (floppy-disk-symbol)

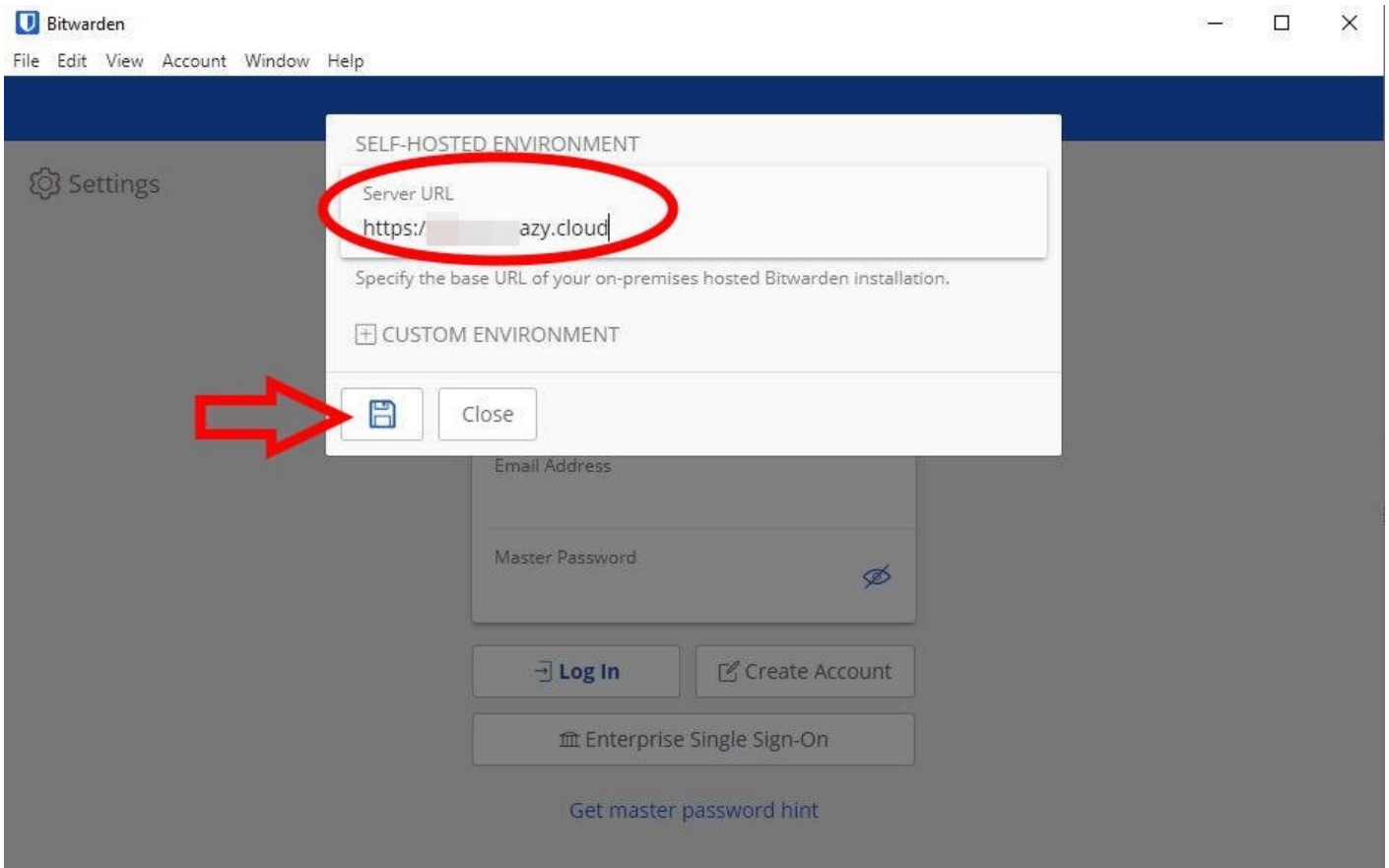

Step 04

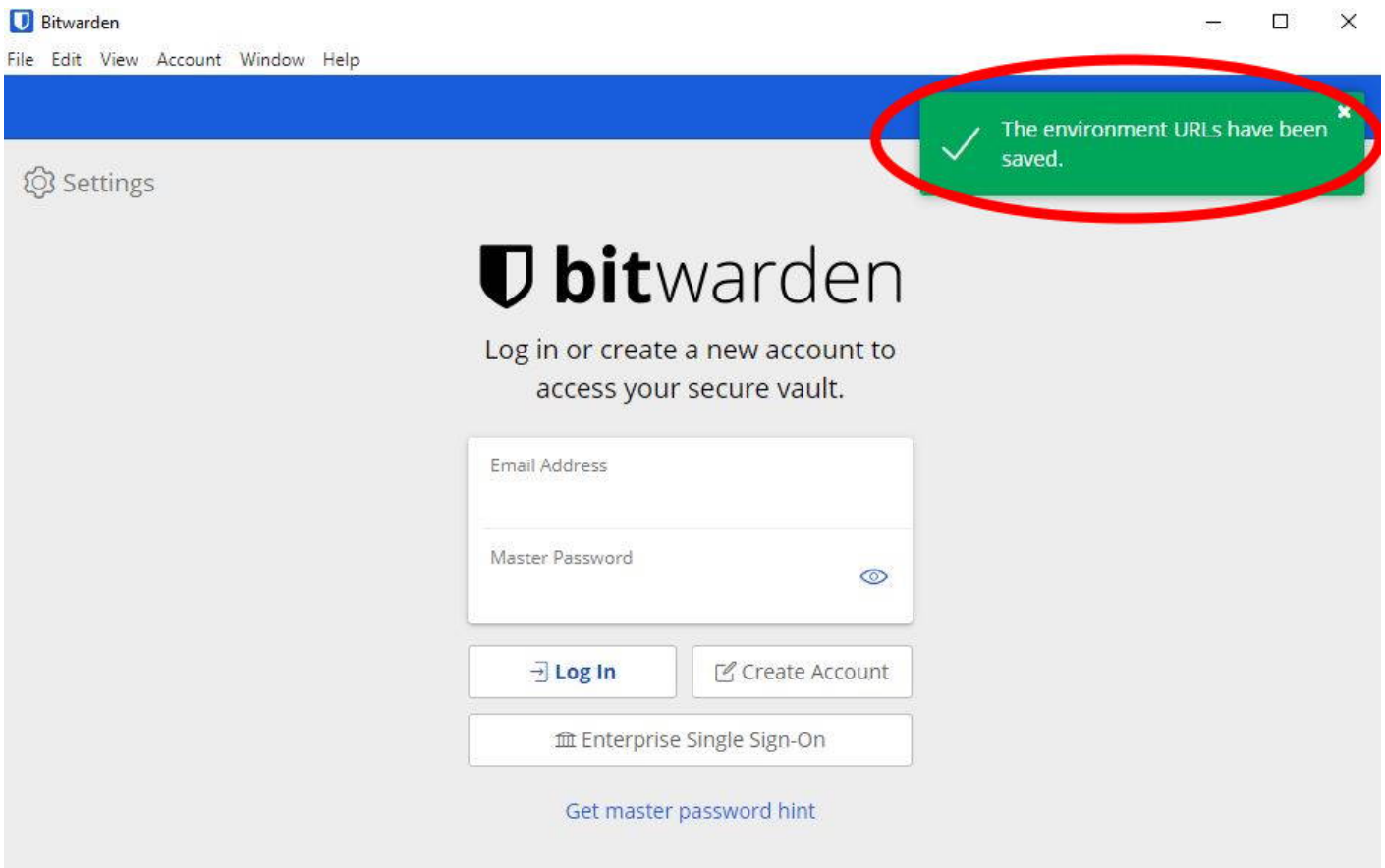

Step 05

- enter your email address and password
- **click ...** (it will only work if you successfully finished this process:

<https://wiki.pv.eazy.cloud/books/bitwarden-password-manager/page/how-do-i-connect-to-bitwarden>)

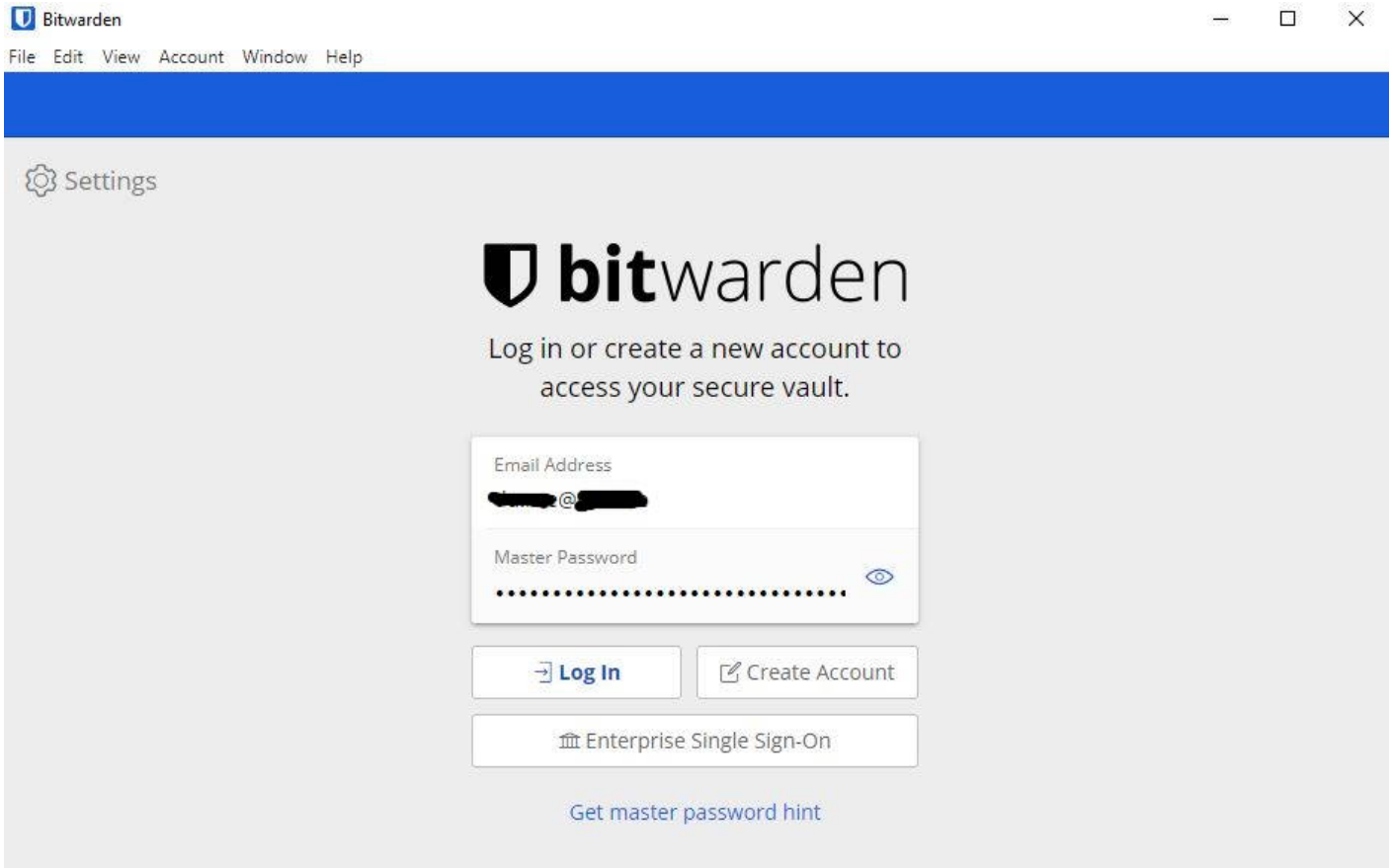

Step 06

- your Bitwarden desktop program is now connected to the Server
- the Startpage of Bitwarden will now look like this:



Your vault is locked. Verify your identity to continue.

Master Password

..... 

Logged in as du.roe@gmx.de on
safe.pv.easy.cloud.

 **Unlock**

Log Out

Revision #5

Created 3 May 2022 07:51:06

Updated 7 March 2024 01:02:49 by Thorsten Voigt